

# RICCAR®



POWER UNIT  
OWNER'S MANUAL  
FOR ALL MODELS

RICCAR®  
[www.riccar.com](http://www.riccar.com)

CENTRAL VACUUM SYSTEM

# Contents

<b>IMPORTANT SAFETY INSTRUCTIONS</b>	2
<b>Polarization Instructions</b>	3
<b>Installation of Power Unit</b>	4
<b>Maintenance and Care</b>	6
<b>Problem Solving Guide</b>	10
<b>Warranty</b>	11

# IMPORTANT SAFETY INSTRUCTIONS

When using an electrical appliance, basic precautions should always be followed, including the following:

## READ ALL INSTRUCTIONS BEFORE USING THIS APPLIANCE

**WARNING:** The manufacturer cannot accept responsibility for damage caused when the appliance is not used according to the instructions, or for uses other than those for which it was intended.

To reduce the risk of fire, electric shock or injury:

- Do not leave appliance when plugged in. Unplug from outlet when not in use and before servicing.
- **WARNING:** ELECTRIC SHOCK COULD OCCUR IF USED OUTDOORS OR ON WET SURFACES.
- Do not allow to be used as a toy. Close attention is necessary when used by or near children.
- Use only as described in this manual. Use only manufacturer's recommended attachments.
- Do not use with damaged cord or plug. If appliance is not working as it should, has been dropped, damaged, left outdoors, or dropped into water, return it to your Authorized Retailer for service.
- Do not pull or carry by cord, use cord as a handle, close a door on the cord, or pull cord around sharp edges or corners. Do not run appliance over cord. Keep cord away from heated surfaces.
- Do not unplug by pulling on cord. To unplug, grasp the plug, not the cord.
- Do not handle plug or appliance with wet hands.
- Do not put any object into openings. Do not use with any opening blocked; keep free of dust, lint, hair and anything that may reduce air flow.
- Keep hair, loose clothing, fingers and all parts of body away from openings and moving parts.
- Do not pick up anything that is burning or smoking, such as cigarettes, matches or hot ashes.
- Do not use without vacuum bag and/or filters in place.
- Turn off all controls before unplugging.
- Use extra care when cleaning on stairs.
- Do not use to pick up flammable or combustible liquids such as gasoline or use in areas where they may be present.
- Do not attempt to service the unit while appliance is plugged in.

**SAVE THESE INSTRUCTIONS.**  
FOR HOUSEHOLD USE

# Polarization Instructions

## GROUNDING INSTRUCTIONS

This appliance must be grounded. If it should malfunction or breakdown, grounding provides a path of least resistance for electric current to reduce the risk of electric shock. This appliance is equipped with a cord having an equipment-grounding conductor and grounding plug. The plug must be inserted into an appropriate outlet that is properly installed and grounded in accordance with all local codes and ordinances.

## WARNING:

Improper connection of the equipment-grounding conductor can result in a risk of electric shock. Check with a qualified electrician or service person if you are in doubt as to whether the outlet is properly grounded. Do not modify the plug provided with the appliance – if it will not fit the outlet, have a proper outlet installed by a qualified electrician.

This appliance is for use on a nominal 120-volt circuit and has a grounding attachment plug that looks like the plug illustrated below. Make sure that the appliance is connected to an outlet having the same configuration as the plug. No adaptor should be used with this appliance.

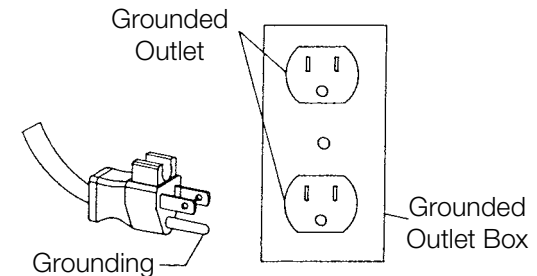

## Installation of Power Unit

Your power unit requires adequate ventilation. Do not lay objects on the top of the unit, as they may obstruct ventilation and possibly cause the motor to overheat.

Using the mounting plate provided with your power unit, secure the unit to the wall (figure 1) at a height that allows for easy access for maintenance of the dirt container, filters and / or bags. The unit should be installed about 3 feet from the floor and 2 feet from the ceiling. The exhaust (for units not vented outside) must be installed at least 3 feet from any adjacent wall. You should have an electric outlet within 3 feet from your unit.

### Sound Suppression System

Some Riccar central power units include a sound suppression muffler (figure 2) for quiet operation. This muffler should be attached to the exhaust port and pointed upward (for units that use bags) or pointed in the direction of the external vent (for units that vent the air outside).

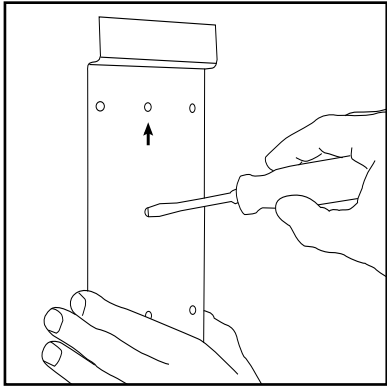

Figure 1

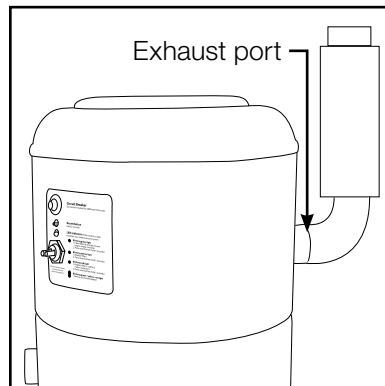

Figure 2

## Installation of Power Unit

Once the power unit is installed in a suitable place, connect it to an electric outlet on a grounded independent circuit. Do not use an extension cord or modify the length of your power unit's cord.

Connect the low-voltage wires to the terminals on your power unit (figure 3). Your central vacuum cleaner has a thermal safety device or circuit breaker to protect against any over voltage or electrical defect. If that protection should fail, contact your authorized service center.

Connect the main suction duct to the power unit's air intake (figure 4). Do not permanently fix the last fitting to your unit—use electrical tape to seal this joint.

Test the operation of the power unit by inserting the vacuum hose into the utility inlet. If the power unit does not start, contact your authorized service center.

If you find installing your central vacuum cleaner is difficult, contact an authorized service center. When in doubt, it is better to have the work done by a professional and ensure the unit is installed properly. Any installation that does not comply with the specified norms could alter or invalidate the warranty.

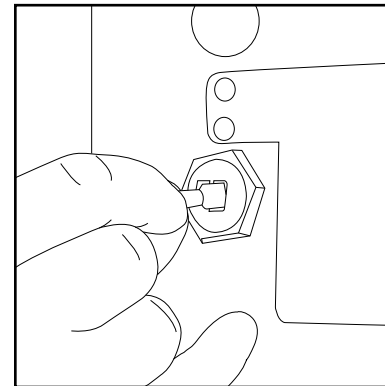

Figure 3

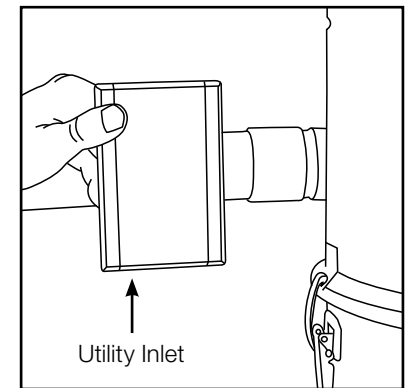

Figure 4

## Maintenance and Care

Your central vacuum system requires regular maintenance of the dirt container, filters and / or bags. Note the motor does not require lubrication.

### Emptying the Dirt Container (For Bagless Units)

Occasional maintenance of your dirt container is necessary to ensure long lasting performance. Empty it regularly (when half-full), depending on the use of your central vacuum system. To empty the dirt container, first disconnect the power unit from its power source. Then release the two clamps (figure 5), lower the container and empty it. Re-attach the container to the power unit, fasten the two clamps and reconnect the power unit to its power source.

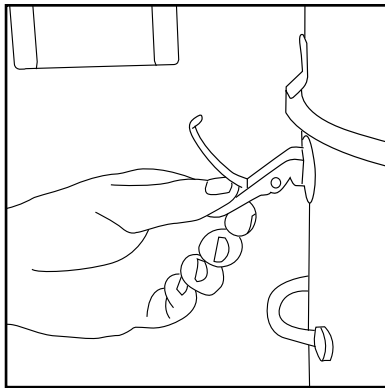

Figure 5

### Maintaining Your Filter (For Bagless Units)

Your central vacuum system is equipped with a Teflon\* self-cleaning, permanent HEPA filter. This filter is designed to ensure high performance and long term reliability of your vacuum motor(s). It's recommended to clean the filter when emptying the dirt container.

\*Teflon is a registered trademark of E.I. du Pont de Nemours company and is used under license by APC Filtration, INC.

## Maintenance and Care

To clean the filter, first remove the dirt container (see "Emptying the Dirt Container" page 6). Next, remove the filter by grabbing the filter strap and pulling the filter downward (figure 6). You may shake the filter, wash the filter or replace the filter. Before re-installing the filter, inspect it for tears or punctures. If damaged or worn, replace with a new filter. Do not re-install a damaged filter or one that is still wet or damp.

Carefully install the filter in the support groove (figure 7) to ensure adequate protection of the motor(s).

Note: When washing the filter, wash in cold water (no bleach) and dry at a low temperature. It is important that the filter is completely dry before it is re-installed.

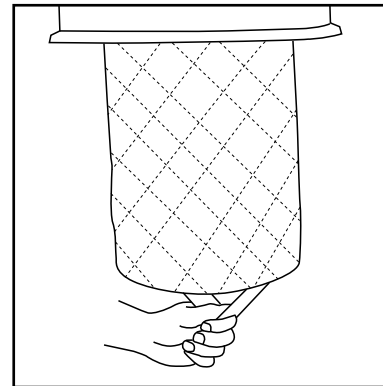

Figure 6

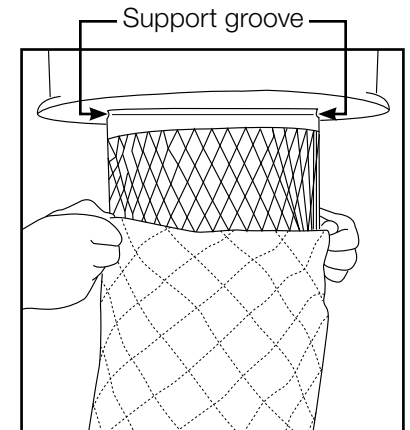

Figure 7

## Maintenance and Care

### Changing the HEPA Bag

For models equipped with a High Flow HEPA bag, replace the bag when it's two-thirds full. The disk-shaped filter, located between the bag and the motor, should be changed after every three bags or more often, if needed.

### Maintenance Alert System

Your Riccar power unit is equipped with an electronic timing board that will suggest, depending on the color of the flashing light, the type of maintenance required. These signals are only suggestions and do not indicate a problem with your unit. Your central vacuum will continue to work normally despite the flashing lights. When you initially connect your unit, the light will be green and steady.

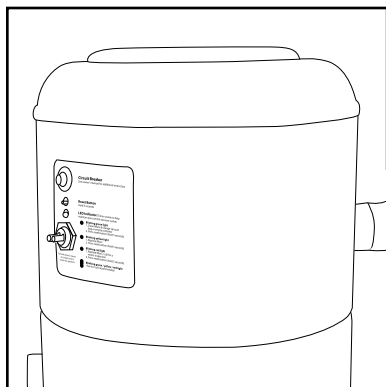

Figure 8

## Maintenance and Care

### Alert System Legend

#### Signal Light

Blinking green

Blinking yellow

Blinking red

Blinking green / yellow / red

#### Maintenance Suggestion

1. Clean the filter and change the HEPA bag or empty the dirt container.
2. To reset the electronic timing board, hold the reset button for 5 seconds.

1. Change the filter.
2. To reset the electronic timing board, hold the reset button for 5 seconds.

1. Change the filter and have an authorized service center inspect the motor. A tune up may be required.
2. To reset the electronic timing board, hold the reset button for 5 seconds.

1. An inspection of the power unit is highly recommended. Your power unit has accumulated a high number operating hours and may require maintenance.
2. To reset the electronic timing board, hold the reset button for 5 seconds.

## Problem Solving Guide

### Circuit Breaker Trips

Your Riccar central vacuum includes a circuit breaker that will shut off your power unit in the event of a problem with the motor. One common reason why a breaker will trip is in response to the motor overheating most likely due to a clog in the system.

If your breaker trips, the source of the problem will have to be detected and remedied before the breaker situation can be resolved. Check to see if the bag or dirt container is full and empty it, if necessary. Also check to see if the filter is clogged. Clean or replace the filter, if necessary. Then unplug the unit, reset the circuit breaker and plug the unit back in. Test to see if the unit will start up. If the unit trips immediately, contact your authorized service center for assistance (1-888-6-RICCAR).

### Trouble Shooting Guide

Problem	Possible Reasons	Possible Solution
Vacuum system won't turn on	<ul style="list-style-type: none"> <li>• Unit not firmly plugged in</li> <li>• Blown fuse or tripped breaker</li> <li>• Needs service</li> </ul>	<ul style="list-style-type: none"> <li>• Plug unit in firmly</li> <li>• Check house fuse or breaker Replace fuse / reset breaker</li> <li>• Talk to authorized service center (1-888-6-RICCAR)</li> </ul>
Vacuum won't pick up or has low suction	<ul style="list-style-type: none"> <li>• Vacuum bag / dirt container is full</li> <li>• Filter is clogged</li> <li>• Power nozzle belt is broken</li> </ul>	<ul style="list-style-type: none"> <li>• Change the bag or empty the dirt container</li> <li>• Replace / wash filter</li> <li>• Replace broken belt</li> </ul>

## Lifetime Limited Warranty

### What is Covered / How Long Coverage Lasts:

All permanently installed components of a Riccar central system are warranted to be free of defects in material and workmanship under normal use to the original purchaser at the original installation address. Motor and electrical components are warranted for ten (10) years.

All Riccar central system accessories are warranted to be free from defects in material and workmanship under normal use for three (3) years from the date of original consumer purchase.

In the event of a defect in permanently installed components of a Riccar central system, an authorized Riccar retailer should be contacted. The retailer will repair or replace (at our option) any defective part or parts at your location at no labor cost for a period of three (3) years. Thereafter, repaired or replacement (at our option) part or parts will be provided to you for items under warranty.

### What is Not Covered:

- Damage to the central vacuum which occurs from neglect, abuse, alterations, accident, misuse or improper maintenance.
- This warranty does not extend to any power nozzle accessory kit or accessories used in conjunction with this power unit. Riccar power nozzle accessory kits are covered under a separate warranty.

### What Riccar Will Do:

This warranty provides, at no cost to you, all labor and parts to keep this central vacuum power unit in correct operating condition during the warranted period.

### How to Get Service:

Warranty service can only be obtained by contacting an Authorized Riccar Retailer. A proof-of-purchase and product serial number will be required before service is rendered. To locate your nearest Riccar Retailer, please call 1-888-6-RICCAR or visit the Riccar website at [www.riccar.com](http://www.riccar.com).

THIS WARRANTY IS EXCLUSIVE AND IN LIEU OF ANY AND ALL OTHER WARRANTIES WHETHER WRITTEN, ORAL, EXPRESSED OR IMPLIED, (INCLUDING ANY WARRANTY OF MERCHANTABILITY OR FITNESS FOR A PARTICULAR PURPOSE), THIS WARRANTY DISCLAIMS LIABILITY FOR INCIDENTAL, OR CONSEQUENTIAL DAMAGES.

### How State Law Applies:

This warranty gives you specific legal rights, and you may also have other rights which vary from state to state.

